

# DEMOLITION OF WALL AND ADDING LVL BEAM



**RENDERING**  
FOR ILLUSTRATION ONLY



## GENERAL NOTES:

THIS PLAN SET, COMBINED WITH THE BUILDING CONTRACT, PROVIDES BUILDING DETAILS FOR THE RESIDENTIAL PROJECT. THE CONTRACTOR SHALL VERIFY THAT SITE CONDITIONS ARE CONSISTENT WITH THESE PLANS BEFORE STARTING WORK. WORK NOT SPECIFICALLY DETAILED SHALL BE CONSTRUCTED TO THE SAME QUALITY AS SIMILAR WORK THAT IS DETAILED. ALL WORK SHALL BE DONE IN ACCORDANCE WITH INTERNATIONAL BUILDING CODES AND LOCAL CODES. CONTRACTOR SHALL BE RESPONSIBLE AND BEAR ANY FINES OR PENALTIES FOR CODE, ORDINANCE, REGULATION OR BUILDING PROCESS VIOLATIONS. INSURANCES SHALL BE IN FORCE THROUGHOUT THE DURATION OF THE BUILDING PROJECT.

WRITTEN DIMENSIONS AND SPECIFIC NOTES SHALL TAKE PRECEDENCE OVER SCALED DIMENSIONS AND GENERAL NOTES. THE ENGINEER/DESIGNER SHALL BE CONSULTED FOR CLARIFICATION IF SITE CONDITIONS ARE ENCOUNTERED THAT ARE DIFFERENT THAN SHOWN, IF DISCREPANCIES ARE FOUND IN THE PLANS OR NOTES, OR IF A QUESTION ARISES OVER THE INTENT OF THE PLANS OR NOTES. CONTRACTOR SHALL VERIFY AND IS RESPONSIBLE FOR ALL DIMENSIONS (INCLUDING ROUGH OPENINGS). ALL TRADES SHALL MAINTAIN A CLEAN WORK SITE AT THE END OF EACH WORK DAY.

PLEASE SEE ADDITIONAL NOTES CALLED OUT ON OTHER SHEETS.

## BUILDING DESIGN AND CODE DATA:

NOTE: THIS WAS A PURPOSE DRAWING Branch Circuitry and Panel designations to be designed and installed by certified local electrician. L.S. (NFPA 101 LIFE SAFETY CODE) AS APPLICABLE.

APPLICABLE BUILDING CODES:

- INTERNATIONAL BUILDING CODE 2018
- INTERNATIONAL RESIDENTIAL CODE 2018
- INTERNATIONAL PLUMBING CODE 2018
- INTERNATIONAL MECHANICAL CODE 2018
- NATIONAL ELECTRICAL CODE 2020

**CONSTRUCTION TYPE: (BASED ON CHAPTER 5 OF THE IBC)**

CONSTRUCTION TYPE: V B  
FIRE RATINGS FOR BUILDING ELEMENTS (BASED ON SECTION 602.1 & TABLES 601 & 602 OF THE IBC):

**FIRE PROTECTION SYSTEMS SUMMARY:**

AN AUTOMATIC FIRE SPRINKLER SYSTEM AS DESCRIBED PER IBC SECTION 903 IS NOT REQUIRED.

## CODE INFORMATION:

### PROJECT DESCRIPTION:

DEMOLITION OF WALL AND ADDING LVL BEAM

### BUILDING CODE:

INTERNATIONAL BUILDING CODE - 2018

### PROJECT SQUARE FOOTAGE:

EXISTING TO REMAIN

### CHAPTER 3- CLASSIFICATION:

EXISTING AND PROPOSED:  
R-1 (RESIDENTIAL)

### CHAPTER 5- HEIGHT AND AREA:

EXISTING TO REMAIN

### CHAPTER 6- CONSTRUCTION TYPE:

EXISTING TO REMAIN

### CHAPTER 7- FIRE SEPARATION AND RATINGS:

EXISTING TO REMAIN

### CHAPTER 8- INTERIOR FINISH RATINGS:

EXISTING TO REMAIN:

### CHAPTER 9- FIRE PROTECTION:

EXISTING TO REMAIN

### CHAPTER 9- FIRE AND SMOKE ALARMS:

EXISTING TO REMAIN

### CHAPTER 10- MEANS OF EGRESS:

EXISTING TO REMAIN

### CHAPTER 29- PLUMBING FIXTURES:

EXISTING TO REMAIN

OWNER: [REDACTED]  
PROJECT: DEMOLITION OF WALL AND ADDING LVL BEAM  
ADDRESS: [REDACTED]

WATER/SEWER: PUBLIC/SEPTIC TANK  
BUILDING PERMIT: GEORGIA  
PARCEL ID : 0109-0297-013

COUNTY: BARTOW  
OCCUPANCY CLASSIFICATION USE: R-1 RESIDENTIAL

ARCHITECT NAME : ASWIN KUMAR  
ARCHITECT CONTACT : +1 302-889-1886  
DESIGN CONSULTANT : TRANSFORMATIVE CONSTRUCTION  
BUILDER: TBD

## INDEX

Label	Title
G01	PROJECT SUMMARY
G02	GENERAL NOTES
A01	PROPOSED FLOOR PLAN
A02	LVL BEAM

ARCHITECT SEAL:

**PROJECT  
SUMMARY**

SCALE @ 24" X 36"

DATE: 10-16-2024

DRAWN BY: AK

8735 Dunwoody Place  
#6694, Atlanta, GA 30350  
unifiedstudioarchitect.com  
Ph: 302 889 1886

**Unified**  
Studio Architect

SHEET NUMBER

**G01**

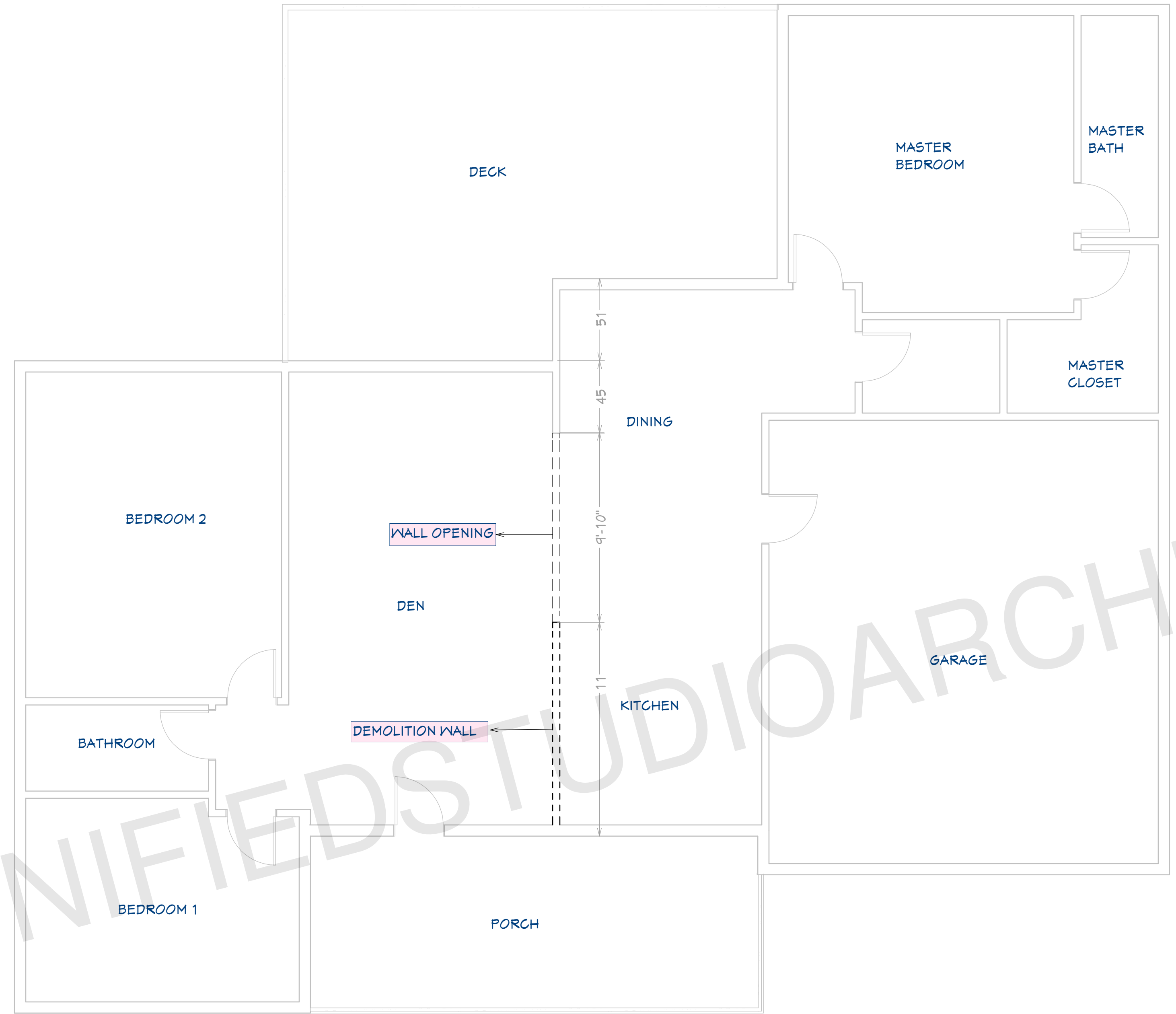

**LEGEND**

	WALLS TO BE RETAINED
	DEMOLITION WALL

**FLOOR PLAN NOTES:**

- 1 ALL EXTERIOR DIMENSIONS ARE TO THE FRAMING OR MAIN LAYER.
- 2 CONTRACTOR SHALL VERIFY ALL DIMENSIONS AND IS RESPONSIBLE FOR ALL DIMENSIONS (INCLUDING ROUGH OPENINGS).

**PROPOSED FLOOR PLAN**  
1/2"=1'

ARCHITECT SEAL:

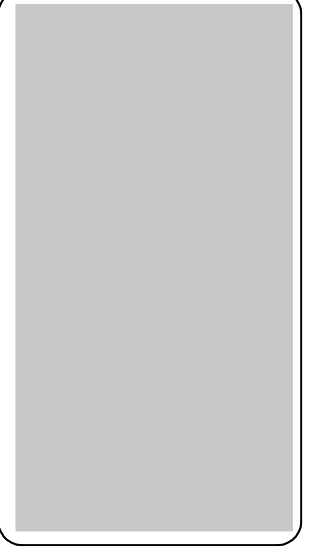

**FLOOR PLAN**

SCALE @ 24" X 36"

DATE: 10-16-2024

DRAWN BY: AK

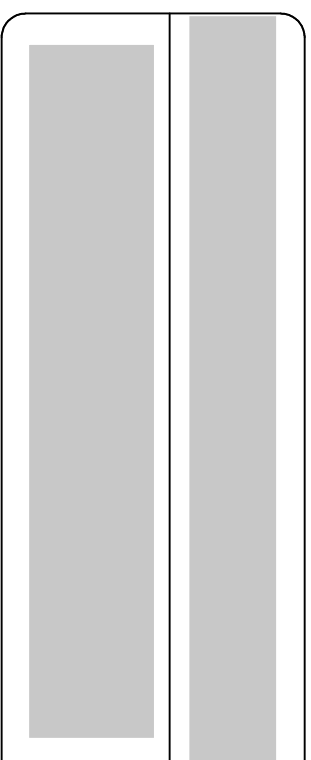

8735 Dunwoody Place  
#6694, Atlanta, GA 30350  
unifiedstudioarchitect.com  
Ph: 302 889 1886

SHEET NUMBER

**A02**

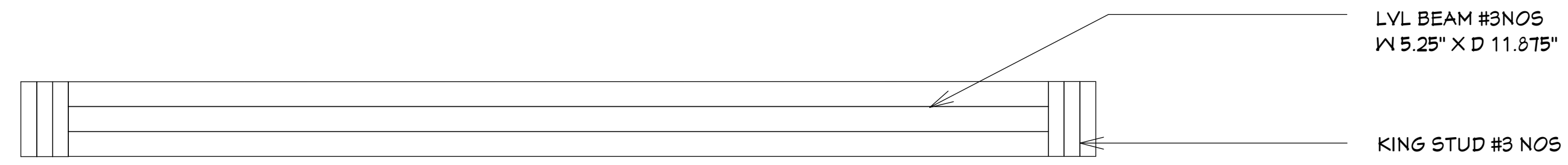

PLAN VIEW

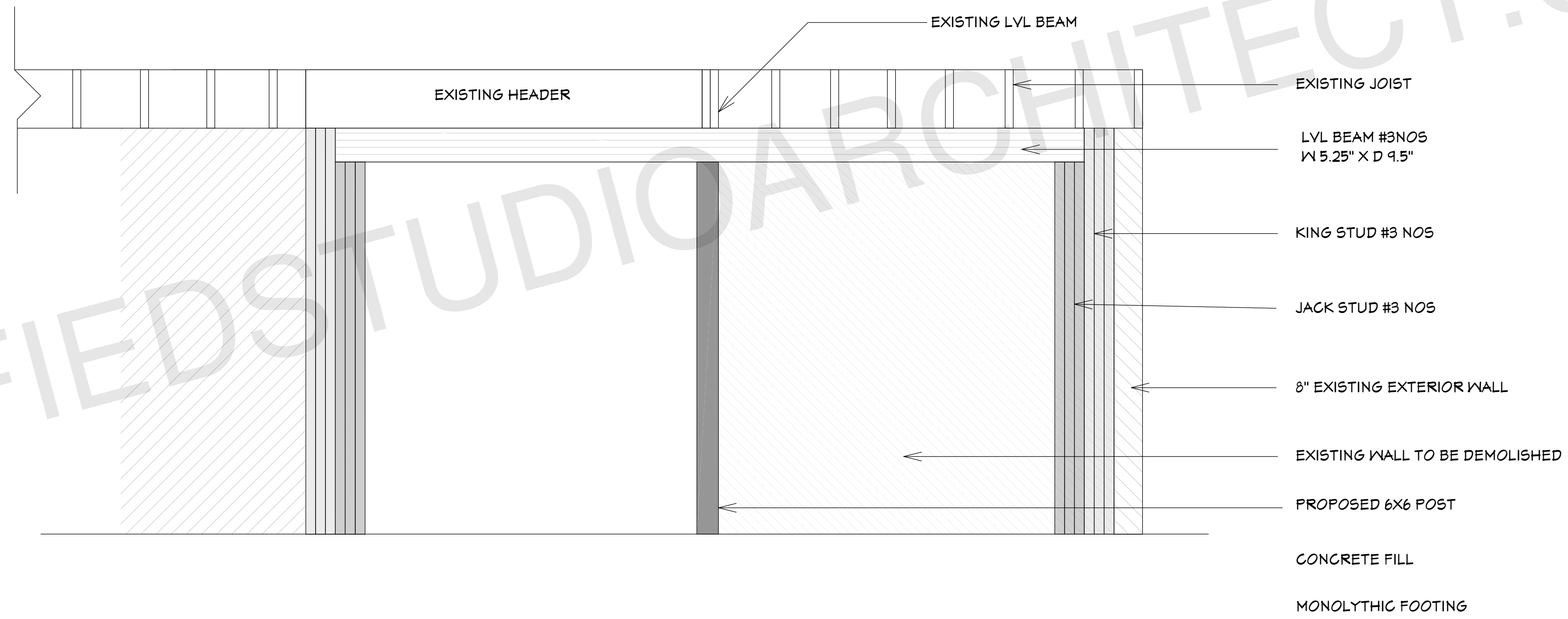

ELEVATION

UNIFIEDSTUDIOARCHITECT.COM

ARCHITECT SEAL:



**LVL BEAM**

SCALE @ 24" X 36"

DATE: 10-16-2024

DRAWN BY: AK

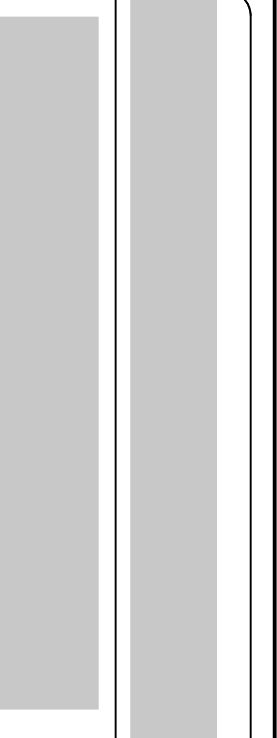

8735 Dunwoody Place  
 #6694, Atlanta, GA 30350  
 unifiedstudioarchitect.com  
 Ph: 302 889 1886



SHEET NUMBER

**A03**