

CONVENIENCE STORE STRIP MALL

226 GREENVILLE STREET; LAN LOT 7, 6TH DISTRICT, NEWNAN, GEORGIA 30263

ARCHITECT SEAL:

PROJECT SUMMARY

SCALE @ 24" X 36"

DATE: 10-16-2024

DRAWN BY: AK

8735 Dunwoody Place
#6694, Atlanta, GA 30350
unifiedstudioarchitect.com
Ph: 302 889 1886

SHEET NUMBER

G01

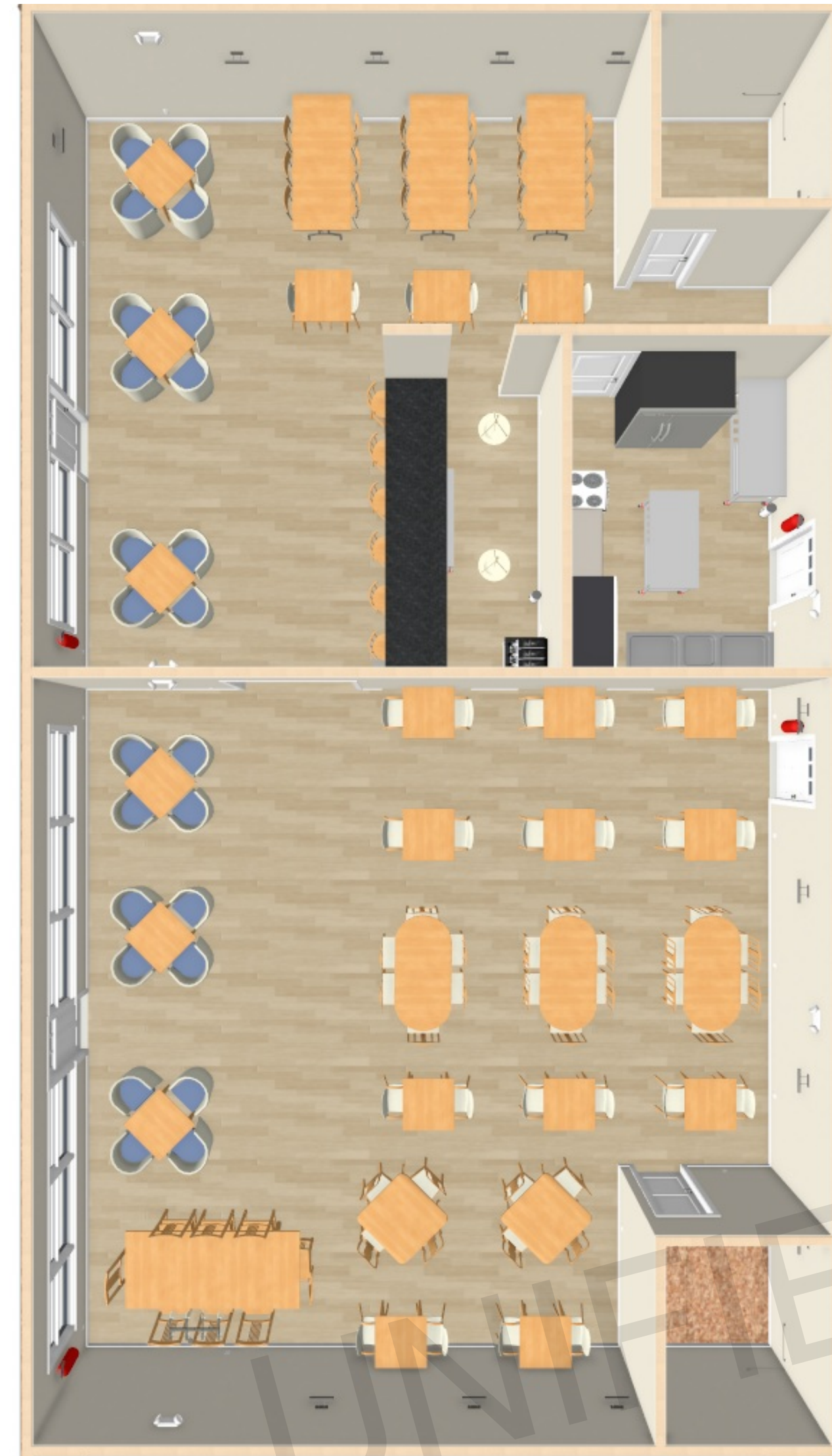

RENDERING
NOT TO SCALE

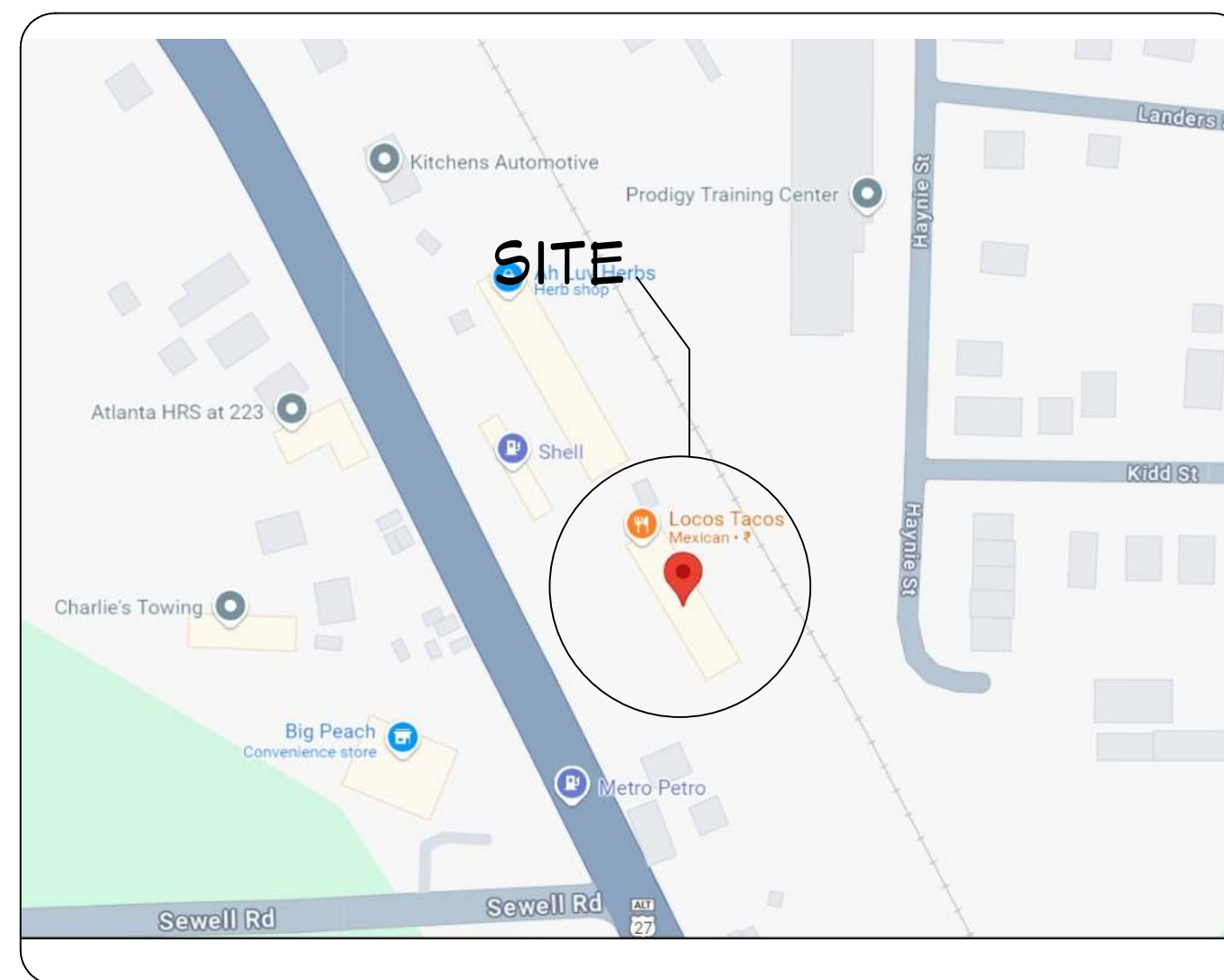

VICINITY MAP
NOT TO SCALE

GENERAL NOTES:

THIS PLAN SET, COMBINED WITH THE BUILDING CONTRACT, PROVIDES BUILDING DETAILS FOR THE RESIDENTIAL PROJECT. THE CONTRACTOR SHALL VERIFY THAT SITE CONDITIONS ARE CONSISTENT WITH THESE PLANS BEFORE STARTING WORK. WORK NOT SPECIFICALLY DETAILED SHALL BE CONSTRUCTED TO THE SAME QUALITY AS SIMILAR WORK THAT IS DETAILED. ALL WORK SHALL BE DONE IN ACCORDANCE WITH INTERNATIONAL BUILDING CODES AND LOCAL CODES. CONTRACTOR SHALL BE RESPONSIBLE AND BEAR ANY FINES OR PENALTIES FOR CODE, ORDINANCE, REGULATION OR BUILDING PROCESS VIOLATIONS. INSURANCES SHALL BE IN FORCE THROUGHOUT THE DURATION OF THE BUILDING PROJECT.

WRITTEN DIMENSIONS AND SPECIFIC NOTES SHALL TAKE PRECEDENCE OVER SCALED DIMENSIONS AND GENERAL NOTES. THE ENGINEER/DESIGNER SHALL BE CONSULTED FOR CLARIFICATION IF SITE CONDITIONS ARE ENCOUNTERED THAT ARE DIFFERENT THAN SHOWN, IF DISCREPANCIES ARE FOUND IN THE PLANS OR NOTES, OR IF A QUESTION ARISES OVER THE INTENT OF THE PLANS OR NOTES. CONTRACTOR SHALL VERIFY AND IS RESPONSIBLE FOR ALL DIMENSIONS (INCLUDING ROUGH OPENINGS). ALL TRADES SHALL MAINTAIN A CLEAN WORK SITE AT THE END OF EACH WORK DAY.

PLEASE SEE ADDITIONAL NOTES CALLED OUT ON OTHER SHEETS.

BUILDING DESIGN AND CODE DATA:

NOTE: THIS WAS A PURPOSE DRAWING Branch Circuitry and Panel designations to be designed and installed by certified local electrician. L.S. (NFPA 101 LIFE SAFETY CODE) AS APPLICABLE.

APPLICABLE BUILDING CODES:

- INTERNATIONAL BUILDING CODE 2021
- INTERNATIONAL RESIDENTIAL CODE 2021
- INTERNATIONAL PLUMBING CODE 2021
- INTERNATIONAL MECHANICAL CODE 2021
- NATIONAL ELECTRICAL CODE 2023

OCCUPANCY LOAD AND EGRESS:

EGRESS PATH:

MAXIMUM ALLOWABLE DISTANCE FOR TYPE A-2 CLASSIFICATION = 200'

EGRESS WIDTH:

FOR OCCUPANCY TYPE A+2 CLASSIFICATION (100 SQ.FT./PERSON)

$$\begin{aligned} 2,470/150 &= 16.5 \\ &= 16.5 \times 0.2 \\ &= 3.3' \\ &= 36" \text{ PROVIDED} \end{aligned}$$

OCCUPANCY CALCULATION:

KITCHEN = 180.5 SFT = 2 OCCUPANTS
BAR = 109.5 SFT. = 1 OCCUPANTS
SEATING AREA (UNIT H) = 715.5 SFT. = 48 OCCUPANTS
SEATING AREA (UNIT I) = 1205.5 SFT. = 81 OCCUPANTS

TOTAL OCCUPANTS = 132 OCCUPANTS

CODE INFORMATION:

PROJECT DESCRIPTION:

COMBINING TWO COMMERCIAL SPACE INTO ONE AS RESTAURANT

BUILDING CODE:

INTERNATIONAL BUILDING CODE - 2021

CHAPTER 3- CLASSIFICATION:

EXISTING :
UNISEX SALOON: B CATEGORY
CITY FINANCE : B CATEGORY
PROVIDED:
A-2 (ASSEMBLY)

CHAPTER 5- HEIGHT AND AREA:

EXISTING TO REMAIN

CHAPTER 6- CONSTRUCTION TYPE:

EXISTING TO REMAIN

CHAPTER 7- FIRE SEPARATION AND RATINGS:

EXISTING TO REMAIN

CHAPTER 8- INTERIOR FINISH RATINGS:

EXISTING TO REMAIN:

CHAPTER 9- FIRE PROTECTION:

EXISTING TO REMAIN

CHAPTER 9- FIRE AND SMOKE ALARMS:

EXISTING TO REMAIN

CHAPTER 10- MEANS OF EGRESS:

EXISTING TO REMAIN

CHAPTER 29- PLUMBING FIXTURES:

3- WATER CLOSET AND 3- LAVATORY PROVIDED

PROJECT INFORMATION:

OWNER : ANTOINE DAVISON
PROJECT : COMBINING COMMERCIAL SPACES INTO A RESTAURANT
ADDRESS : 226 GREENVILLE STREET; LAN LOT 7, 6TH DISTRICT, NEWNAN, GEORGIA 30263
WATER/SEWER : MUNICIPAL ON SITE
BUILDING PERMIT : STATE OF GEORGIA
COUNTY : COWETA, GA
PARCEL ID : N47 0002 001
ARCHITECT NAME : ASWIN KUMAR
ARCHITECT CONTACT : +1 302-889-1886
DESIGN CONSULTANT : TRANSFORMATIVE CONSTRUCTION
BUILDER : TBD
ENGINEERING : ARMENTROUT MATHENY THURMOND, P.C.
ADDRESS : OAKBROOK CORPORATE CAMPUS 330 RESEARCH DRIVE, SUITE A240 ATHENS, GEORGIA 30605-2160
CONTACT : MR. MICHAEL B. THURMOND, PE
TEL : 706-548-8211

INDEX

LABEL	TITLE
G01	PROJECT SUMMARY
G02	GENERAL NOTES
G03	LIFE SAFETY PLAN
G04	ADA SHEET
A01	PROPOSED FLOOR PLAN
A02	EQUIPMENT SCHEDULE
E01	ELECTRICAL NOTES
E02	POWER PLAN
E03	LIGHTING PLAN
P01	PLUMBING NOTES
P02	WATER SUPPLY PLAN
P03	SEWER PLAN
M01	MECHANICAL NOTES
M02	HVAC PLAN

EGRESS PATH:

MAXIMUM ALLOWABLE DISTANCE FOR TYPE A-2 CLASSIFICATION = 200'

EGRESS WIDTH:

FOR OCCUPANCY TYPE A+2 CLASSIFICATION (100 SQ.FT./PERSON)

2,470/150 = 16.5
= 16.5 x 0.2
= 3.3"
= 36" PROVIDED

OCCUPANCY CALCULATION:

KITCHEN = 180.5 SFT = 2 OCCUPANTS
BAR = 104.5 SFT. = 1 OCCUPANTS
SEATING AREA (UNIT H) = 715.5 SFT. = 48 OCCUPANTS
SEATING AREA (UNIT I) = 1205.5 SFT. = 81 OCCUPANTS
TOTAL OCCUPANTS = 132 OCCUPANTS

LEGEND:

- EXIT EXIT SIGN
-  FIRE EXTINGUISHER
-  EMERGENCY LIGHT
-  EGRESS PATH

EGRESS AND FIRE NOTES

1. FIRE EXTINGUISHER CABINET (FEC) SHALL BE WALL BE EITHER CABINET TYPE OR WALL HUNG. RATED CABINETS TO MATCH CLASS OF REQUIRED EXTINGUISHER.
2. APPROVED BUILDING NUMBER AND ADDRESS SHALL BE PLACED IN SUCH A POSITION AS TO BE PLAINLY VISIBLE AND LEGIBLE FROM THE STREET OR ROAD FRONTING THE PROPERTY. SAID NUMBERS SHALL CONTRAST WITH THEIR BACKGROUND.
3. AT ANY TIME THE BUILDING IS OCCUPIED, THE MEANS OF EGRESS SHALL BE ILLUMINATED AT AN INTENSITY OF NOT LESS THAN 1 FOOT-CANDLE AT FLOOR LEVEL. IN THE EVENT OF POWER SUPPLY FAILURE, AN EMERGENCY ELECTRICAL SYSTEM SHALL AUTOMATICALLY ILLUMINATE ALL EGRESS COMPONENTS INCLUDING AISLES, EGRESS STAIRWAYS, AND CORRIDORS FOR NOT LESS THAN 90 MINUTES AND SHALL BE EQUIPPED WITH STORAGE BATTERIES.
4. EXIT DOORS SHALL BE OPERABLE FROM THE INSIDE WITHOUT THE USE OF A KEY OR ANY SPECIAL KNOWLEDGE OR EFFORT.
5. PROVIDE TACTILE EXIT SIGNS AT EXIT DOORS
6. DEVICE LOCATIONS ARE DIAGRAMMATIC - REFER TO EGRESS PLANS FOR LAYOUT LOCATIONS AND EXIT ACCESS TRAVEL DISTANCES.
7. EXIT SIGNS - MOUNTED AT STOREFRONT SYSTEMS - MOUNT TO FRAME AT DOOR HEAD
8. CONTRACTOR SHALL PROVIDE TACTILE SIGNS AT LOCATIONS REQUIRED BY ADA

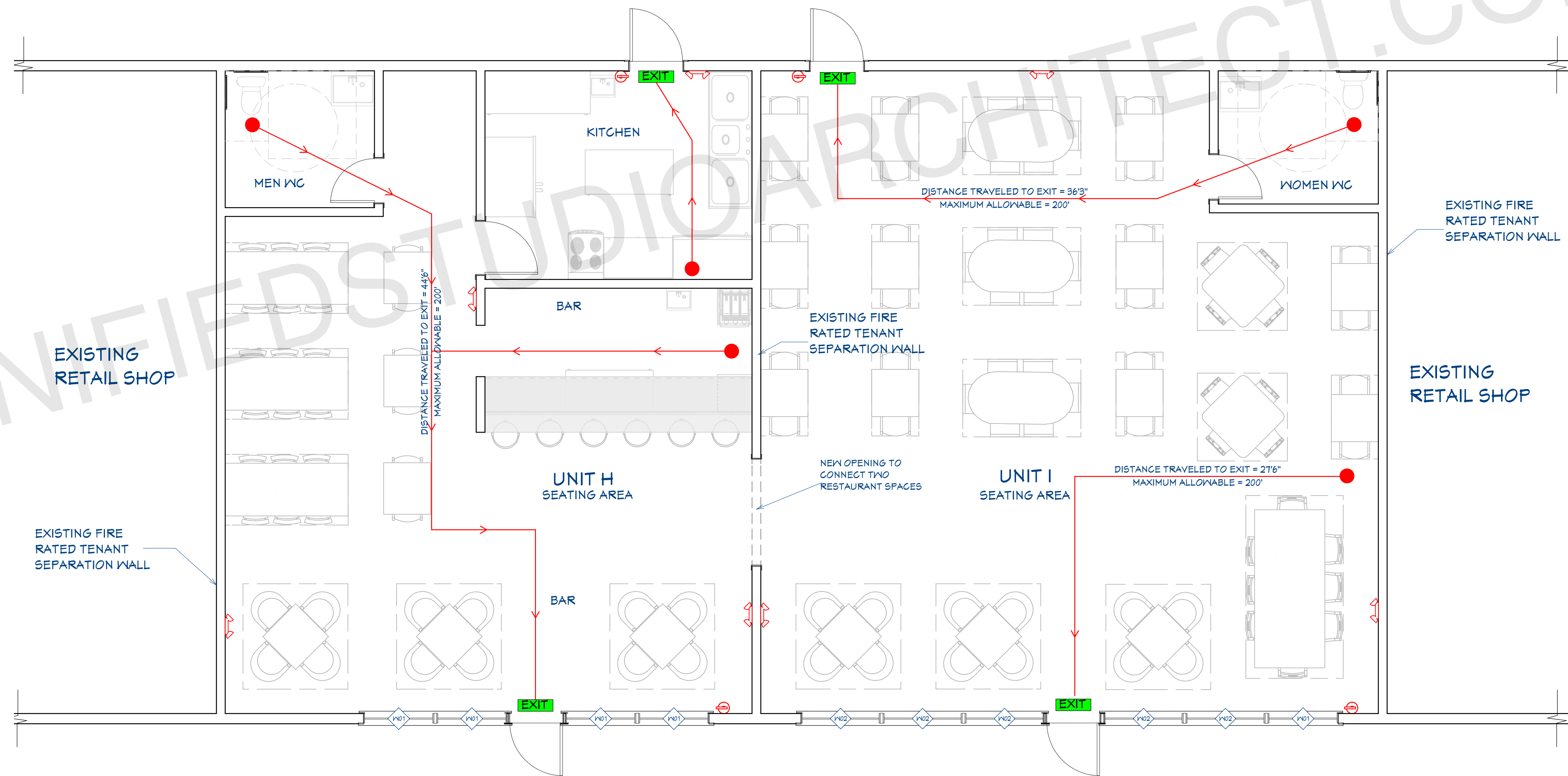

FIRE SAFETY PLAN

1/4"=1'

ARCHITECT SEAL:

FIRE SAFETY PLAN

SCALE @ 24" X 36"

DATE: 10-16-2024

DRAWN BY: AK

8735 Dunwoody Place
#6694, Atlanta, GA 30350
unifiedstudioarchitect.com
Ph: 302 889 1886



SHEET NUMBER

A02

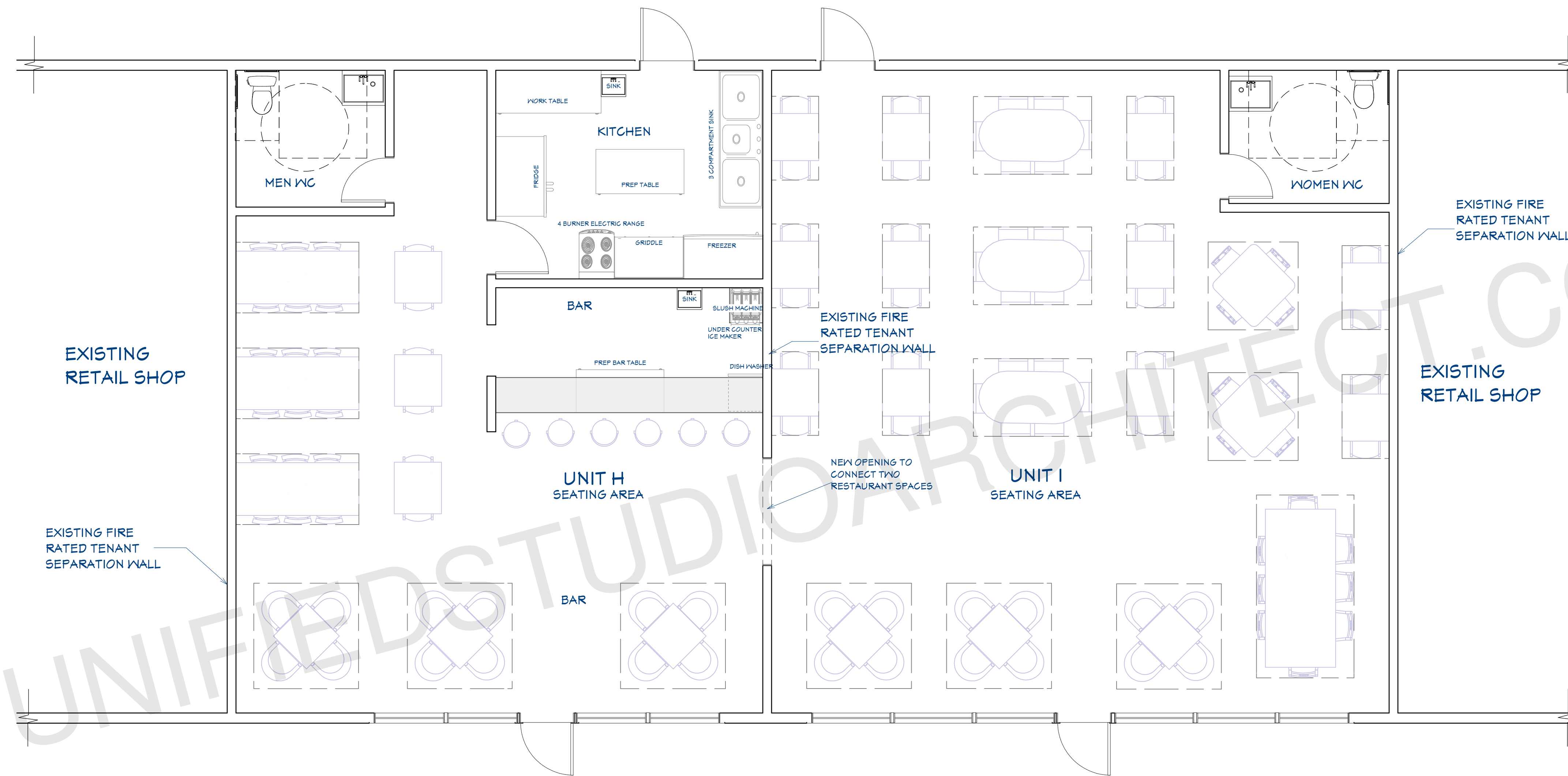

PROPOSED FLOOR PLAN
1/4"=1'

DOOR SCHEDULE				
NUMBER	WIDTH	HEIGHT	DESCRIPTION	QTY
D01	30"	80"	HINGED-DOOR P04	2
D02	36"	80"	HINGED-DOOR P04	1
D03	36"	80"	EXT. HINGED-DOOR E21	4

WINDOW SCHEDULE				
NUMBER	WIDTH	HEIGHT	DESCRIPTION	QTY
W01	48"	48"	DOUBLE HUNG	5
W02	54"	48"	DOUBLE HUNG	5

FLOOR PLAN NOTES:

- 1 ALL EXTERIOR DIMENSIONS ARE TO THE FRAMING OR MAIN LAYER.
- 2 CONTRACTOR SHALL VERIFY ALL DIMENSIONS AND IS RESPONSIBLE FOR ALL DIMENSIONS (INCLUDING ROUGH OPENINGS).
- 3 FLOOR/CEILING SYSTEM SHALL BE INSPECTED TO DETERMINE FIRE RATINGS. FIRE RATING FOR TENANT OCCUPANCY WALL SHALL BE 2 HOURS. FIRE RATING FOR FLOOR/CEILING ABOVE RESTAURANT SHALL BE 2 HOURS.

ARCHITECT SEAL:

FLOOR PLAN

SCALE @ 24" X 36"

DATE: 10-16-2024

DRAWN BY: AK

8735 Dunwoody Place
#6694, Atlanta, GA 30350
unifiedstudioarchitect.com
Ph: 302 889 1886



SHEET NUMBER

A03

NOTE SCHEDULE								
ITEM NO.	MANUFACTURER	DESCRIPTION	PRODUCT DIMENSION	MODEL	POWER USAGE	WATER OUTLET	WATER SUPPLY	QTY
①	REGENCY TABLES & SINKS	30" X 12" 18 GAUGE 304 STAINLESS STEEL COMMERCIAL WORK TABLE WITH UNDERSHELF, 12" OVERSHELF, DRAWER, POT RACK, AND BUN PAN RACK	72" X 30" X 66"	#600WT30T2KIT	NIL	NIL	NIL	1
②	ADVANCE TABCO	PRESTIGE SIGNATURE SERIES UNI-SERV SPEED BAR 30" WIDE UNITS	30" X 60" X 36"	PRU-24-60L-10 OR R-10	15A - 120V DUPLEX RECEPTACLE	1" IPS DRAIN (NON-GOLD PLATE ICE BIN AND GLASSWARE SHELF), 1/2" IPS DRAIN (GOLD PLATE ICE BIN), 3 1/2" BASKET DRAIN (SINK BOWL).	INCLUDES 4" O.C. SPLASH MOUNT GOOSENECK SPOUT FAUCET	1
③	MAIN STREET EQUIPMENT	HTUC HIGH-TEMPERATURE UNDERCOUNTER DISHWASHER - 208V/240V, 1 PHASE	23-5/8" X 24-13/16" X 32-11/16"	#541HTUC30	208/240 VOLTS NEMA 6-20P PLUG TYPE	BUILT-IN DRAIN PUMP	3/4 INCHES INLET	1
④	VEVOR MARGARITA MACHINES	12L X 3 THREE BOWLS COMMERCIAL SLUSHY MACHINE	23.4" X 21.5" X 27.6"	#RLC12X3	85-130V, 1100W	NIL	NIL	1
⑤	AVANTCO ICE MACHINES	UC-F-120-A 19" AIR COOLED UNDERCOUNTER FULL CUBE ICE MACHINE - 129 LB.	19-11/16" X 23-5/16" X 32-1/2"	#194UCF120A	5 AMPS, 60 HERTZ, 1 PHASE, 115 VOLTS 8.7 KW/H PER 100 LBS. NEMA 5-15P PLUG TYPE	YES	3/4 INCHES INLET	1
⑥	REGENCY	WALL-MOUNTED HAND SINK WITH GOOSENECK FAUCET AND SIDE SPLASH	17" X 15" X 13.5"	#600HS17SP	NIL	YES	YES	2
⑦	COOKING PERFORMANCE GROUP	ER24-240-1 24" 4-BURNER ELECTRIC RANGE WITH SPACE SAVER OVEN	24" X 33.75" X 56.875"	#351ER24SD	60 HERTZ, 1 PHASE, 240 VOLTS	NIL	NIL	1
⑧	COOKING PERFORMANCE GROUP	G-CPG-48-M 48" ELECTRIC COUNTERTOP GRIDDLE	47-5/8" X 29" X 15-9/16"	#351GCPG48M	12,000W / 16,000W, 208 / 240V, 60HZ, 1-3 PHASE	NIL	NIL	1
⑨	MAIN STREET EQUIPMENT	BMR-49-R 54" SOLID DOOR REACH-IN REFRIGERATOR (R-290)	54" X 32-3/16" X 82-1/2"	#829BMR49R	115V; 1/3 HP, 4.56 AMPS, 60 HERTZ, 1 PHASE, NEMA 5-15P PLUG TYPE	NIL	NIL	1
⑩	REGENCY	Y 94" 16-GAUGE STAINLESS STEEL THREE COMPARTMENT COMMERCIAL SINK WITH 2 DRAINBOARDS - 18" X 24" X 14" BOWLS	94" X 29-13/16" X 43-3/4"	#600S318242X	NIL	1 1/2" IPS DRAIN OUTLET AND 3 1/2" BASKET STRAINERS	YES	1
⑪	AVANTCO REFRIGERATION	APT-60-HC 60" 2 DOOR REFRIGERATED SANDWICH PREP TABLE (R-290)	60-1/4" X 31" X 42 3/8"	#178APT60HC	5.4 AMPS, 60 HERTZ, 1 PHASE, 115 VOLTS, 540 WATTS, 1/2 HP, NEMA 5-15P PLUG TYPE	NIL	NIL	1
⑫	AVANTCO REFRIGERATION	A-49F-HC 54" SOLID DOOR REACH-IN FREEZER (R-290)	54" X 32-3/16" X 82-1/2"	#178A49FHC	8.5 AMPS, 60 HERTZ, 1 PHASE, 115 VOLTS, 780 WATTS, 1 2/7 HP, NEMA 5-15P PLUG TYPE	NIL	NIL	1

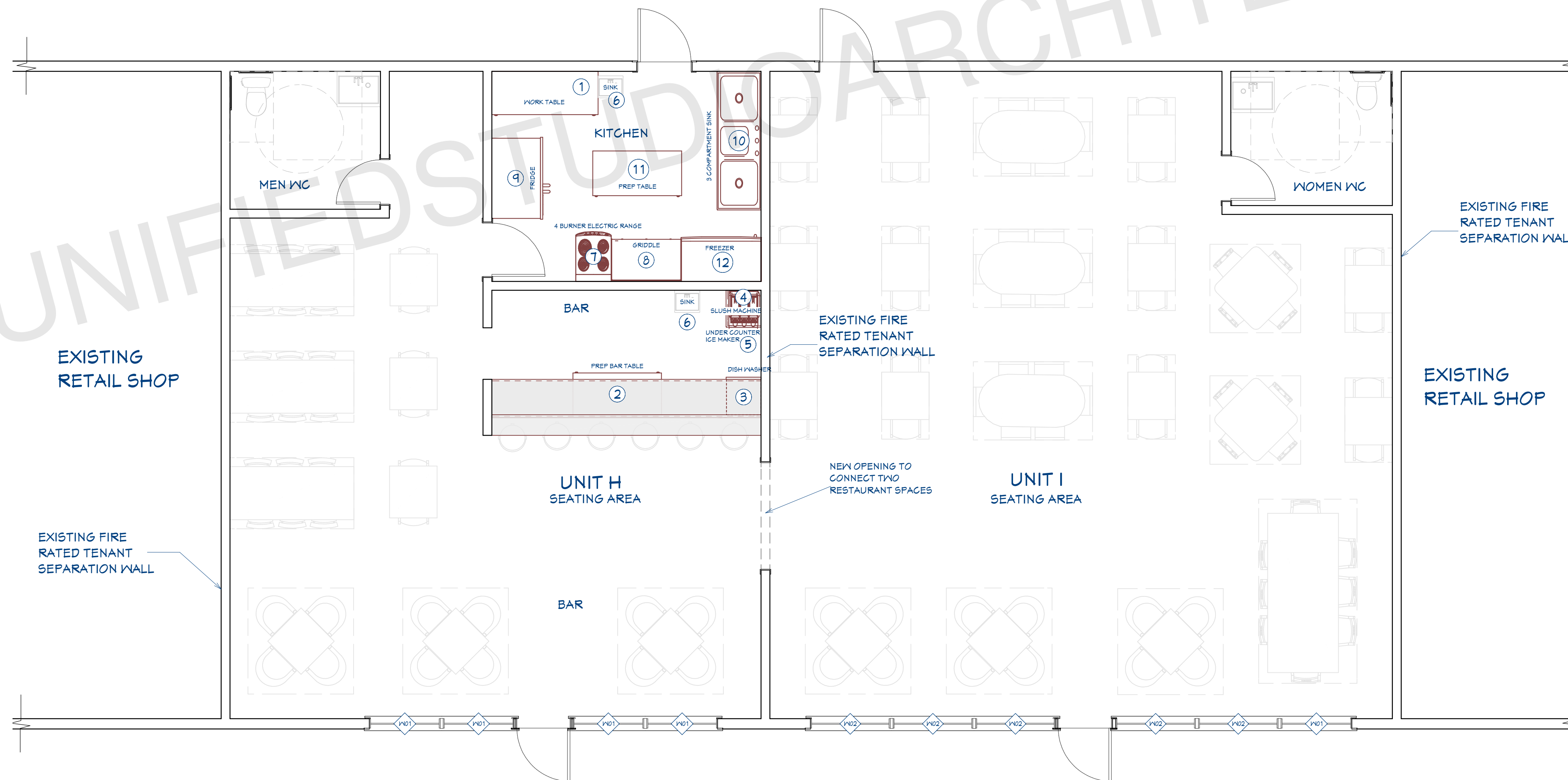

EQUIPMENT LAYOUT
1/4"=1'

ARCHITECT SEAL:

EQUIPMENT SCHEDULE

SCALE @ 24" X 36"

DATE: 10-16-2024

DRAWN BY: AK

8735 Dunwoody Place
#6694, Atlanta, GA 30350
unifiedstudioarchitect.com
Ph: 302 889 1886

SHEET NUMBER

A09

ELECTRICAL LEGEND	
	120-240V OUTLET (RECEPTACLES)
	CONNECTING LINE
	GFCI OUTLET
	HOME RUN
	ELECTRICAL PANEL
	LED LIGHT
	WALL MOUNTED LIGHT
	SWITCHES
	TV OUTLET
	TELEPHONE OUTLET

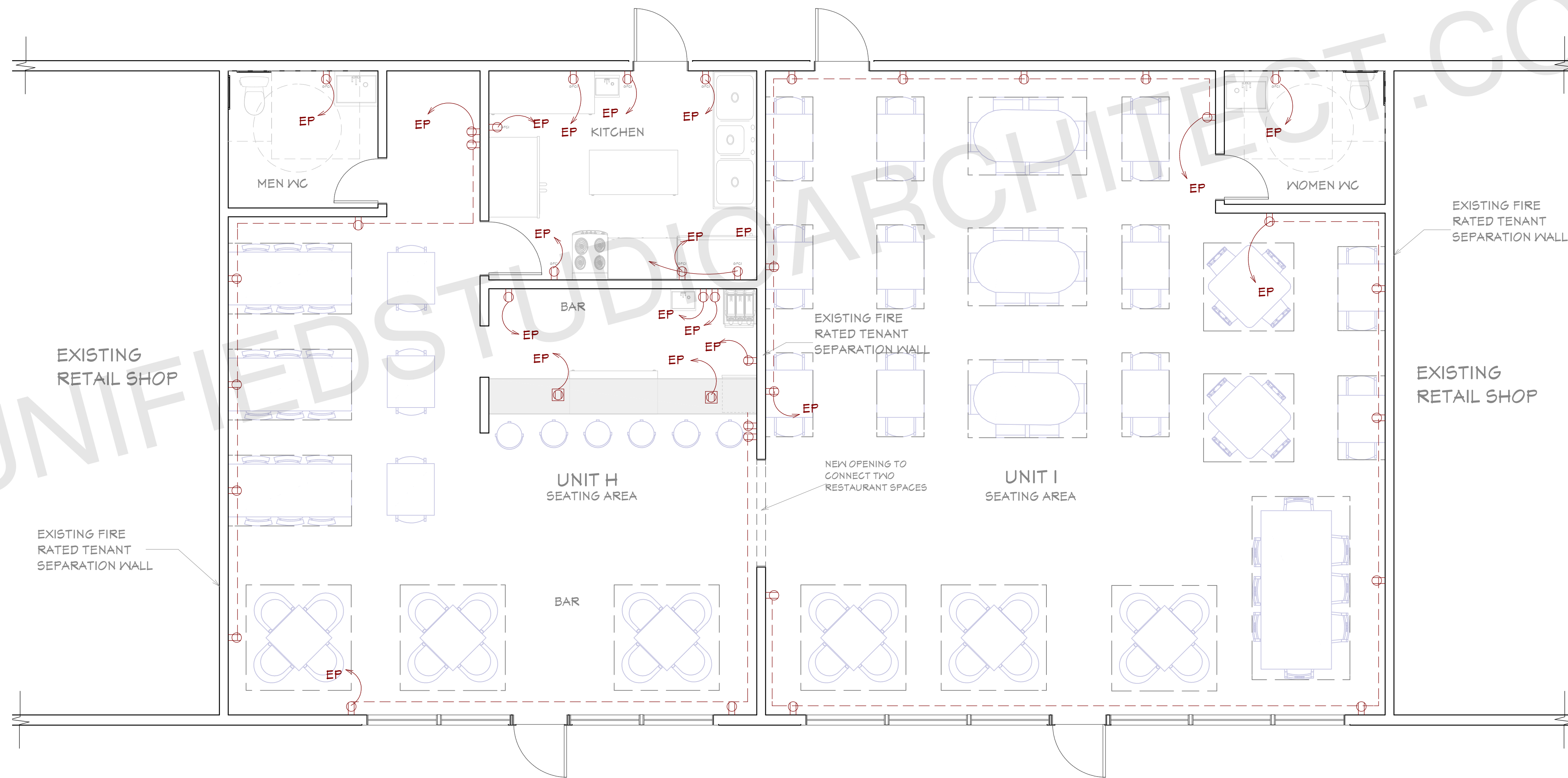

POWER PLAN
1/4"=1'

NOTE: ALL PROPOSED OUTLETS IN KITCHEN AREA AND BATHROOM SHALL BE GFCI PROTECTED

ARCHITECT SEAL:

POWER PLAN

SCALE @ 24" X 36"

DATE: 10-16-2024

DRAWN BY: AK

8735 Dunwoody Place
#6694, Atlanta, GA 30350
unifiedstudioarchitect.com
Ph: 302 889 1886



SHEET NUMBER

A10

ELECTRICAL LEGEND

	110V OUTLET (RECEPTACLES)
	CONNECTION
	CFG OUTLET
	HOME RUN
	ELECTRICAL PANEL
	LED LIGHT
	WALL MOUNTED LIGHT
	SWITCHES
	TV OUTLET
	TELEPHONE OUTLET

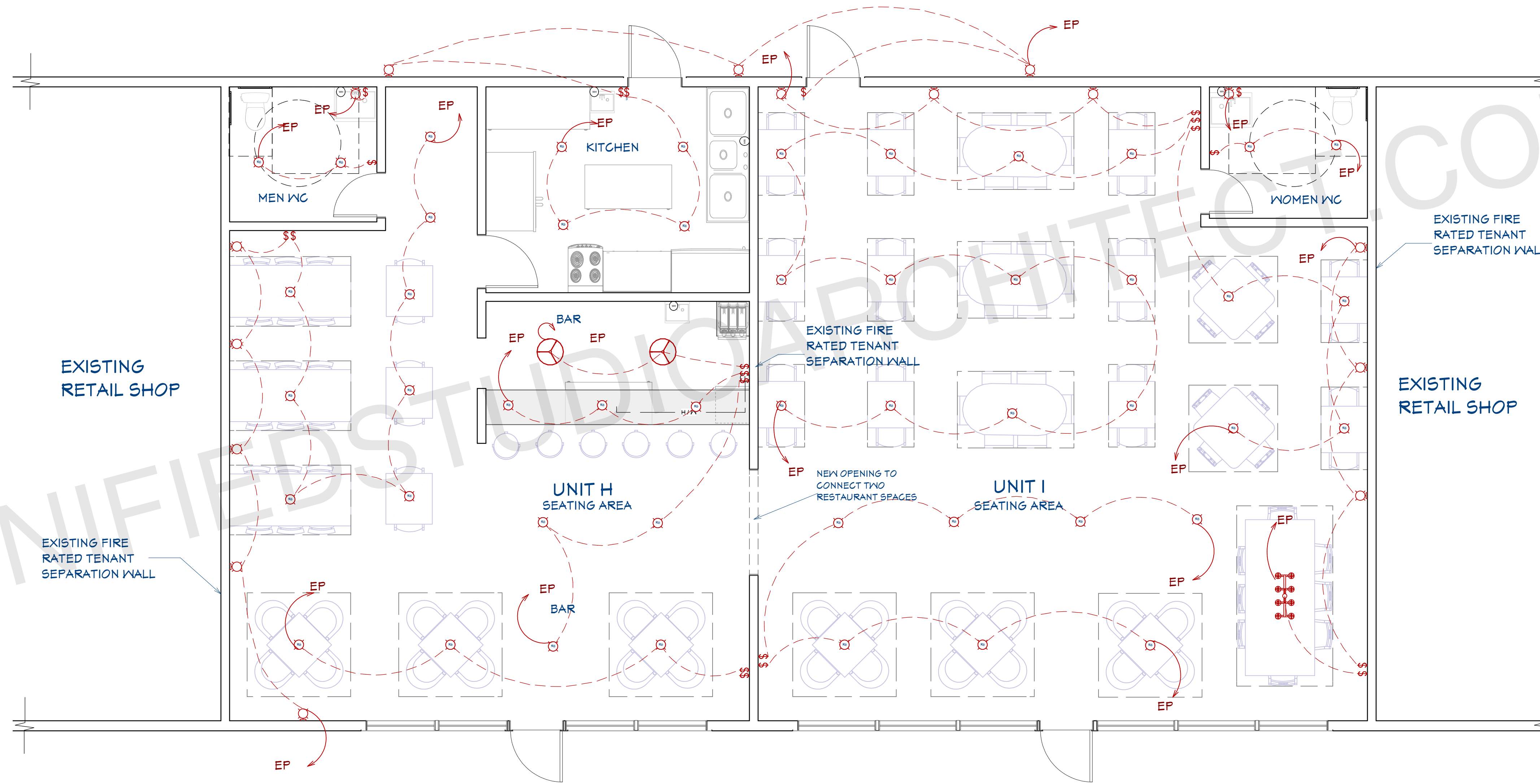

LIGHTING PLAN

1/4"=1'

NOTE: EXISTING FIXTURES ARE TO REMAIN UNLESS OTHERWISE SHOWN.
FIXTURES SHOWN ARE PROPOSED/REPLACED

ARCHITECT SEAL:

LIGHTING PLAN

SCALE @ 24" X 36"

DATE: 10-16-2024

DRAWN BY: AK

8735 Dunwoody Place
#6694, Atlanta, GA 30350
unifiedstudioarchitect.com
Ph: 302 889 1886



SHEET NUMBER

E02

PLUMBING LEGEND	
SYMBOL	DESCRIPTION
— HW —	HOT WATER, COPPER TYPE L, OR CPVC
— W —	COLD WATER, COPPER TYPE L, OR PVC
— SS —	WASTE, PVC, SCHEDULE 40 (DWV)
— — —	VENT, (DWV)

PIPE SIZES:	
Cold Water Pipe Line	= 3/4"
Hot Water Pipe Line	= 1/2"
Sewer Pipe	= 2.5"
Main sewer Pipe	= 3"
Vent	= 2"

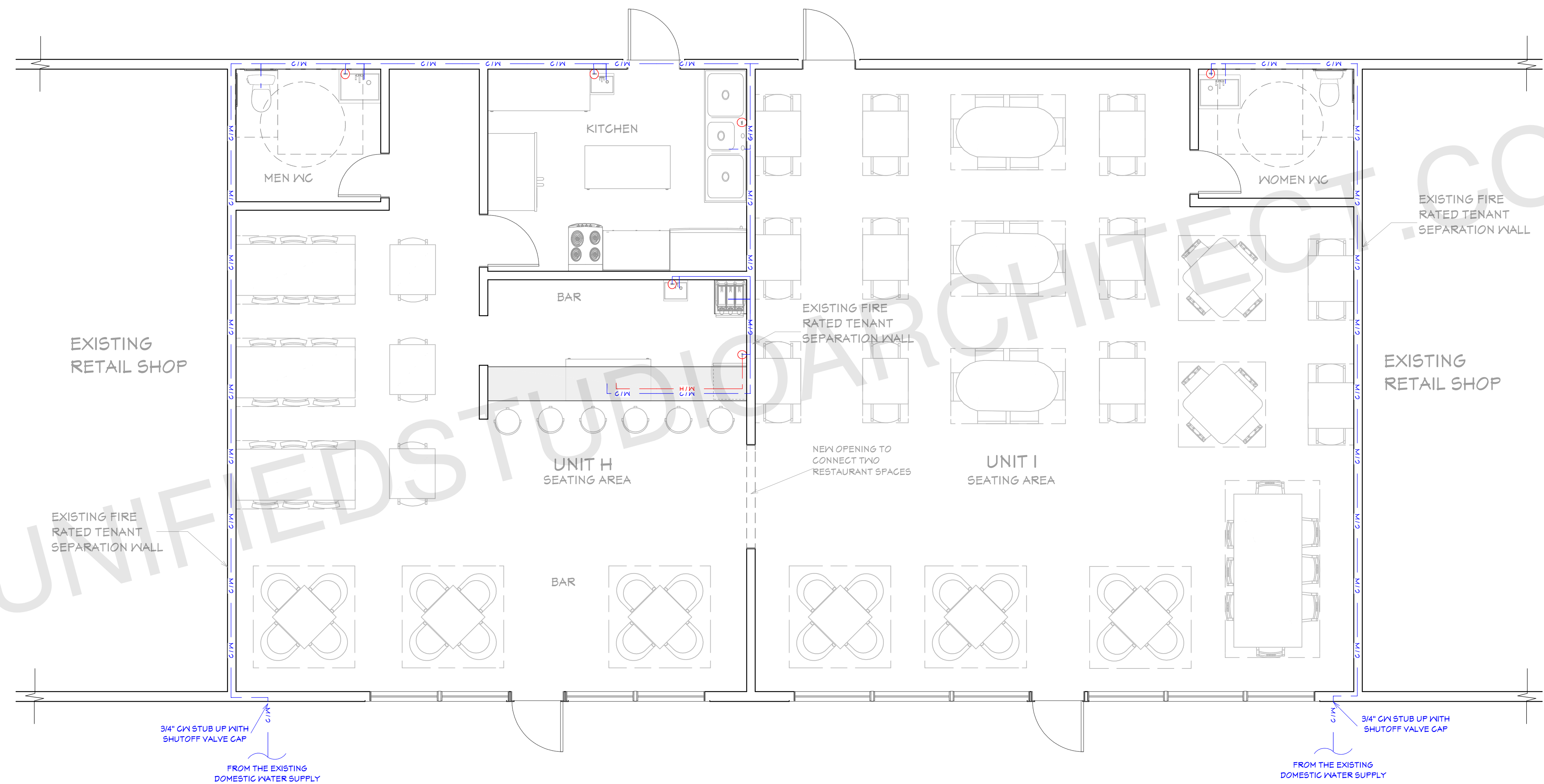

WATER SUPPLY PLAN
1/4"=1'

NOTE: CONTRACTOR TO INSPECT EXISTING PLUMBING TO VERIFY CONDITIONS IN FIELD AND MODIFY AS REQUIRED TO CONNECT NEW FIXTURES.

- NOTE:**
1. POINT-OF-USE ELECTRIC WATER HEATERS IS PLACED NEAR WHERE HOT WATER NEEDED.
 2. RHEEM POINT-OF-USE 2.5 TO 30-GALLON CAPACITIES 1.5 KW THROUGH 6 KW 120, 208, 240, 277 AND 480 VOLTAGES SINGLE PHASE ELECTRIC WATER HEATER.
 3. MODEL EGSP2 WITH WATER CONNECTION OF 1/2" NPT

ARCHITECT SEAL:

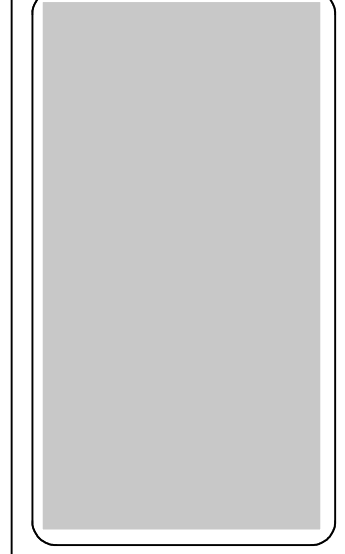

PLUMBING PLAN

SCALE @ 24" X 36"
DATE: 10-16-2024
DRAWN BY: AK

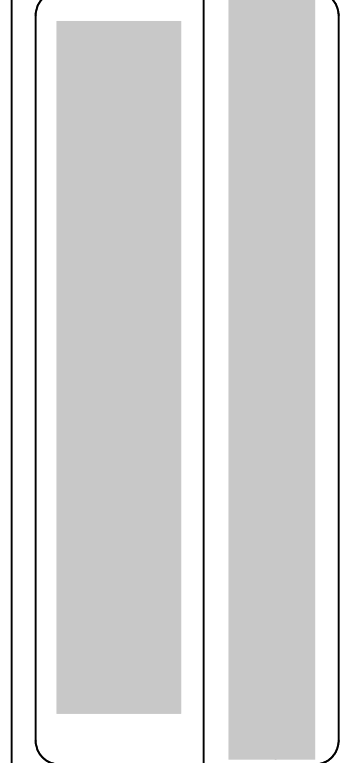

8735 Dunwoody Place
#6694, Atlanta, GA 30350
unifiedstudioarchitect.com
Ph: 302 889 1886

SHEET NUMBER
E03

PLUMBING LEGEND	
SYMBOL	DESCRIPTION
— HW —	HOT WATER, COPPER TYPE L, OR CPVC
— W —	COLD WATER, COPPER TYPE L, OR PVC
— SS —	WASTE, PVC, SCHEDULE 40 (DWV)
— — —	VENT, (DWV)

PIPE SIZES:

Cold Water Pipe Line = 3/4"
 Hot Water Pipe Line = 1/2"
 Sewer Pipe = 2.5"
 Main sewer Pipe = 3"
 Vent = 2"

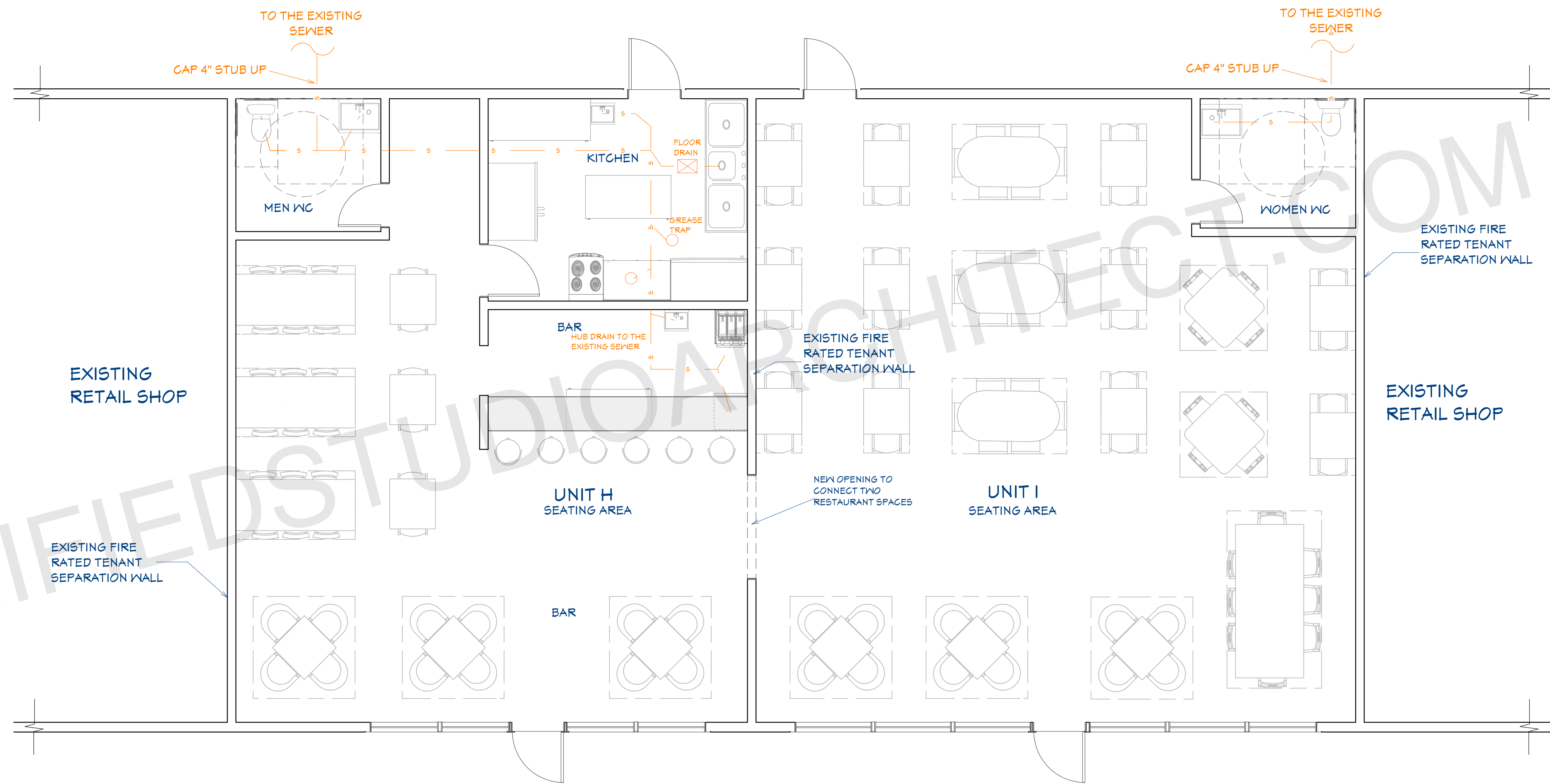

FIRST FLOOR SEWER PLAN

1/4"=1'

ARCHITECT SEAL:

SEWER PLAN

SCALE @ 24" X 36"

DATE: 10-16-2024

DRAWN BY: AK

8735 Dunwoody Place
 #6694, Atlanta, GA 30350
 unifiedstudioarchitect.com
 Ph: 302 889 1886

SHEET NUMBER

P02

ABBREVIATIONS			
AD	ACCESS DOOR	KW	KILOWATT
AFF	ABOVE FINISH FLOOR	LAT	LEAVING AIR TEMPERATURE
AHU-X	AIR HANDLING UNIT	LBS	POUNDS
AJD	ADJUSTABLE	LD	LINEAR SLOT DIFFUSER
AOR	ARCHITECT OF RECORD	LF	LINEAR FEET
BD	BACKDRAFT DAMPER	LR	LINEAR SLOT RETURN
BOD	BASIS OF DESIGN	MA	MAKE UP AIR
BTU	BRITISH THERMAL UNIT	MAU-X	MAKE UP AIR UNIT
BTU/HR	BRITISH THERMAL UNIT PER HOUR	MAX	MAXIMUM
C/C	COOLING COIL	MBH	1,000 BTH/HR
CD	CEILING DIFFUSER	MCA	MAX. CIRCUIT AMPERAGE
CFM	CUBIC FEET PER MINUTE	MIN	MINIMUM
CLG	CEILING	MIL-X	MULTI-SPLIT INDOOR UNIT
COMP-X	COMPRESSOR	MOCP	MAX. OVERCURRENT PROTECTION
CONC	CONCRETE	MOD	MOTORIZED DAMPER
COND	CONDENSATE	MOU-X	MULTI-SPLIT OUTDOOR UNIT
CU-X	CONDENSING UNIT	MD	MANUAL DAMPER
dB	DECIBEL	NO	NORMALLY OPENED
DB	DRY BULB	NC	NORMALLY CLOSED
Ø	DIAMETER	N/A	NOT APPLICABLE
DD	DUCT MOUNTED AIR DIFFUSER	OA	OUTSIDE AIR
DN	DOWN	OC	ON CENTER
DR	DUCT MOUNTED AIR RETURN	OU-X	MINI-SPLIT OUTDOOR UNIT
DWGS	DRAWINGS	PIU-X	POWERED INDUCTION UNIT
EA	EXHAUST AIR	RA	RETURN AIR
EAT	ENTERING AIR TEMPERATURE	RG	RETURN AIR GRILLE
EDH	ELECTRICAL DUCT HEATER	RH	RELATIVE HUMIDITY
EF-X	EXHAUST FAN	RPM	ROTATIONS PER MINUTE
EG	EXHAUST GRILLE	RTU-X	ROOFTOP UNIT
EOR	ENGINEER OF RECORD	SA	SUPPLY AIR
ESP	EXTERNAL STATIC PRESSURE	SF	SQUARE FEET
EX	EXISTING	SP	STATIC PRESSURE
EXH	EXHAUST	SR	SUPPLY REGISTER
FCU-X	FAN COIL UNIT	SS	STAINLESS STEEL
FD	FIRE DAMPER	TG	TRANSFER GRILLE
FSD	FIRE/SMOKE DAMPER	TYP	TYPICAL
FT	FEET	UC	UNDERCUT
H/C	HEATING COIL	UH-X	UNIT HEATER
HP	HORSEPOWER	VAV-X	VARIABLE AIR VOLUME UNIT
HP-X	HEAT PUMP	VFD	VARIABLE FREQUENCY DRIVE
HR	HOUR	W/	WITH
IN	INCHES	WET BULB	WET BULB
IU-X	MINI-SPLIT INDOOR UNIT	WC	WATER COLUMN
KEF-X	KITCHEN EXHAUST FAN	WG	WATER GAUGE

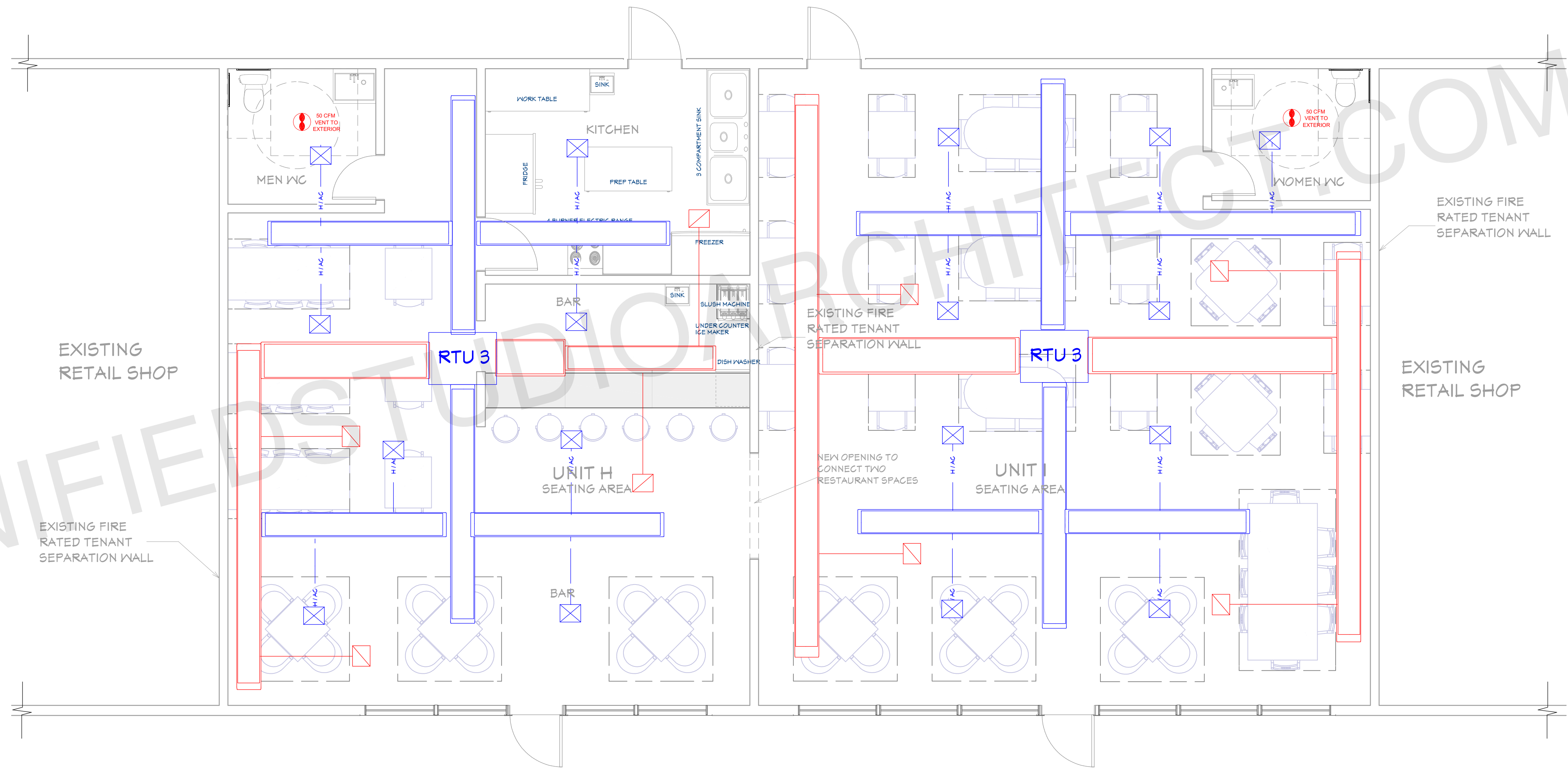
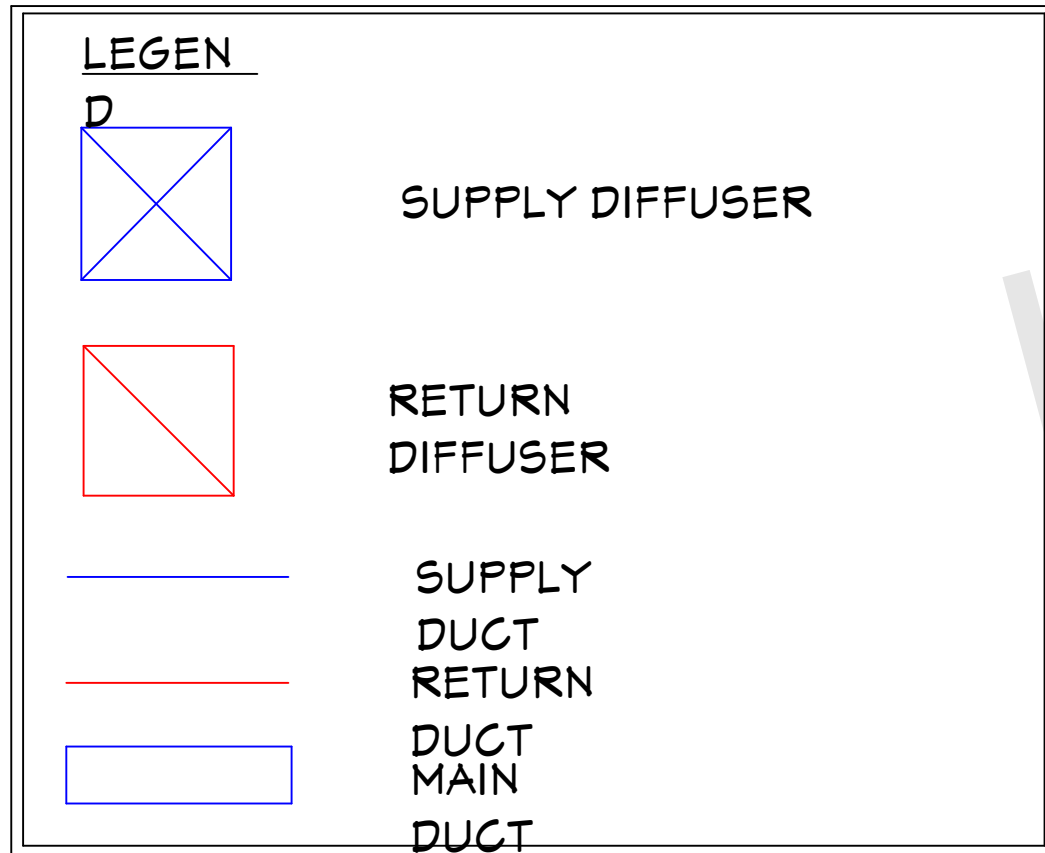

NOTE: CONTRACTOR SHALL INSPECT EXISTING MECHANICAL SYSTEMS TO DETERMINE THAT THE PROPOSED FINAL CONSTRUCTION IS COMPLIANT WITH IMC CHAPTER 4. IN PARTICULAR THE CONTRACTOR SHALL DETERMINE WHETHER APPROPRIATE OUTSIDE AIR VENTILATION IS PROVIDED IN THE FINAL CONSTRUCTION IN ACCORDANCE WITH THE PROPOSED SPACE USE. CONTRACTOR SHALL MAKE ANY NECESSARY MODIFICATIONS REQUIRED TO ENSURE COMPLIANCE WITH IMC.

HVAC PLAN
1/8"=1'

ARCHITECT SEAL:

HVAC PLAN

SCALE @ 24" X 36"

DATE: 10-16-2024

DRAWN BY: AK

8735 Dunwoody Place
#6694, Atlanta, GA 30350
unifiedstudioarchitect.com
Ph: 302 889 1886



SHEET NUMBER

P03